

HMS "VICTORIA" / HMS "SANS PAREIL"
Battleship, 1890

VICTORIA SANS PAREIL

Броненосец "ВИКТОРИЯ" / САНС ПАРЕЙЛЬ,
Великобритания, 1890

1:350

Displacement:
.....11,020 long tons (11,200 t)
Length:.....340 ft (100 m)
Beam:.....70 ft (21 m)
Draught:.....26 ft 9 in (8.15 m)
Installed power:.....8,000 ihp (6,000 kW)
.....(natural draught)
.....14,482 ihp (10,799 kW) (forced draught)

Propulsion:
2 x Humphreys & Tennant triple-expansion engines
2 x screws
Speed:.....16 knots (30 km/h; 18 mph)
.....(natural draught)
.....17.3 kn (19.9 mph; 32.0 km/h) (forced draught)

Complement:430; as flagship: 583

Armament:
2 x BL 16.25 in (413 mm) guns
1 x BL 10 in (250 mm) gun
12 x BL 6 in (150 mm) guns
12 x 6-pounder guns
6 x 14 in (360 mm) torpedo tubes

Armour:
Belt:18 in (460 mm)
Bulkheads:16 in (410 mm)
Turrets:17 in (430 mm)
Redoubt:18 in (460 mm)
Forward screen to battery:6 in (152 mm)
After screen to battery:3 in (76 mm)
Decks:3 in (76 mm)
Conning tower:14 in (360 mm) (sides),
.....2 in (51 mm) (top)

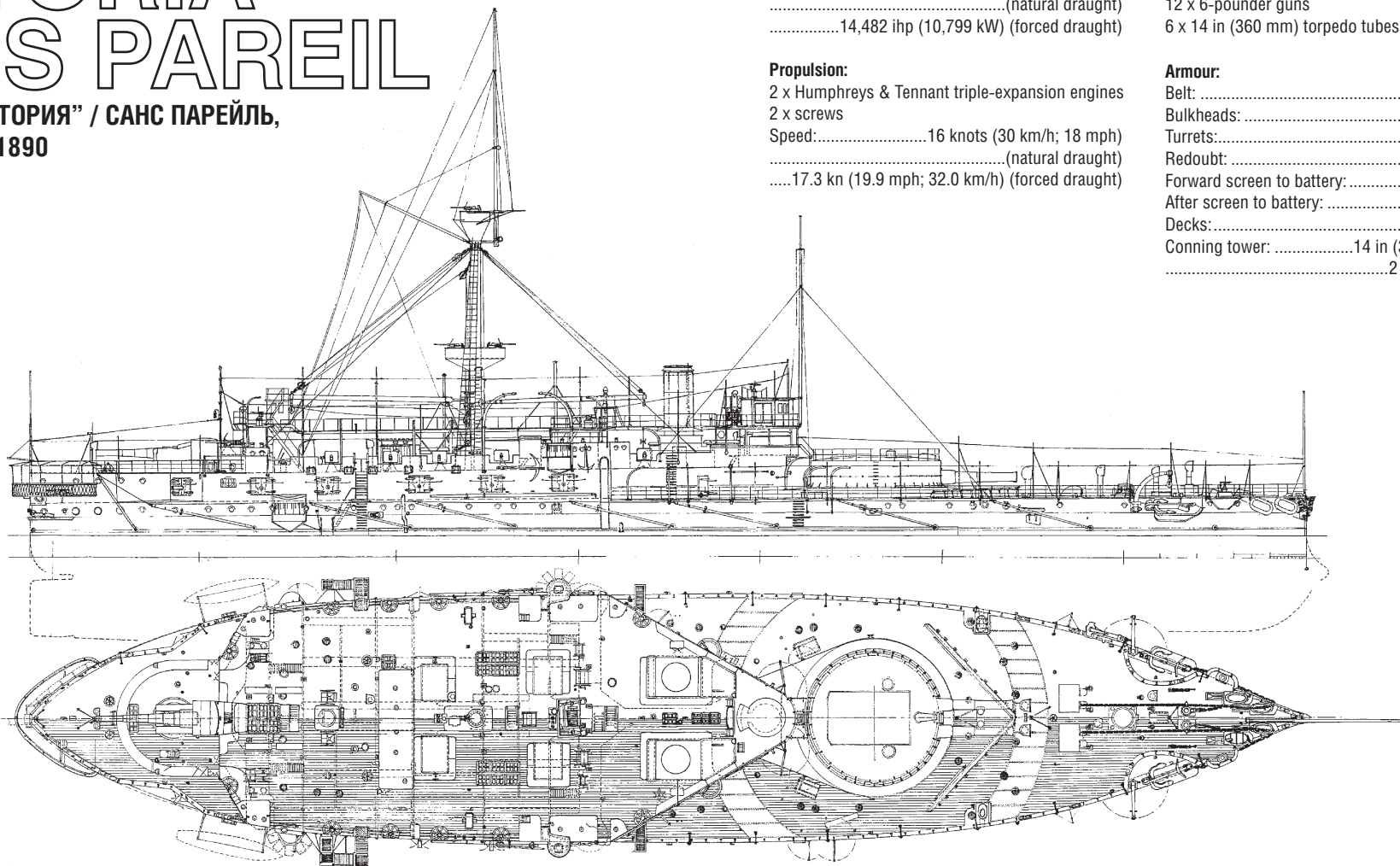

HMS Victoria was the lead ship in her class of two battleships of the Royal Navy. On 22 June 1893, she collided with Camperdown near Tripoli, Lebanon, during manoeuvres and quickly sank, killing 358 crew members, including the

commander of the British Mediterranean Fleet, Vice-Admiral Sir George Tryon. One of the survivors was executive officer of the Victoria, John Jellicoe, later commander-in-chief of the British Grand Fleet at the Battle of Jutland.

3558 For more info on Combrig kits see: www.combrig-models.com www.steelnavy.com www.modelwarships.com

**Ком
Бриг**
Made in Russia

СХЕМА СБОРКИ МОДЕЛИ ASSEMBLY INSTRUCTIONS

1



СХЕМА СБОРКИ МОДЕЛИ ASSEMBLY INSTRUCTIONS

2

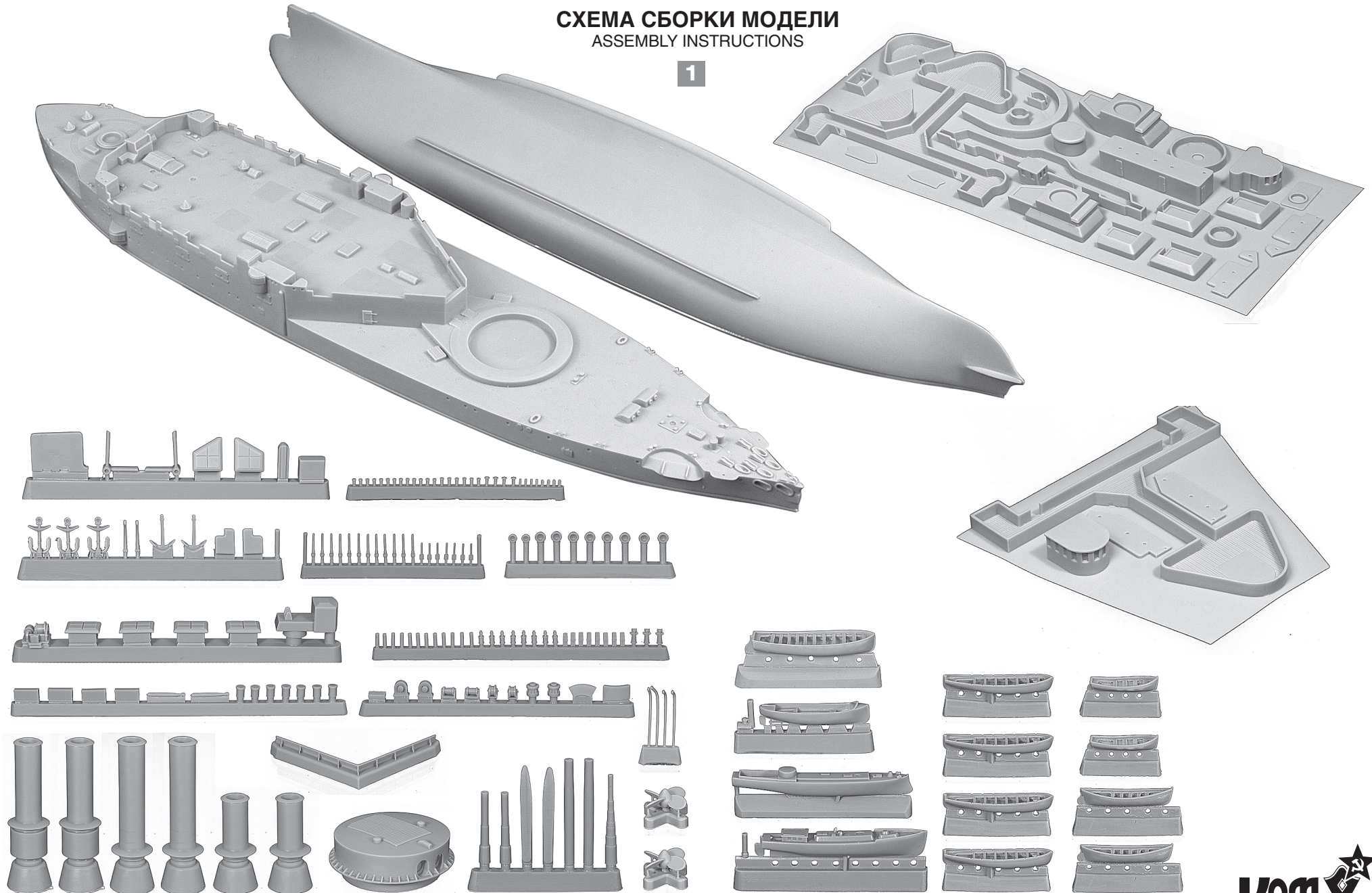

СХЕМА СБОРКИ МОДЕЛИ ASSEMBLY INSTRUCTIONS

3

HMS "VICTORIA" HMS "SANS PAREIL"

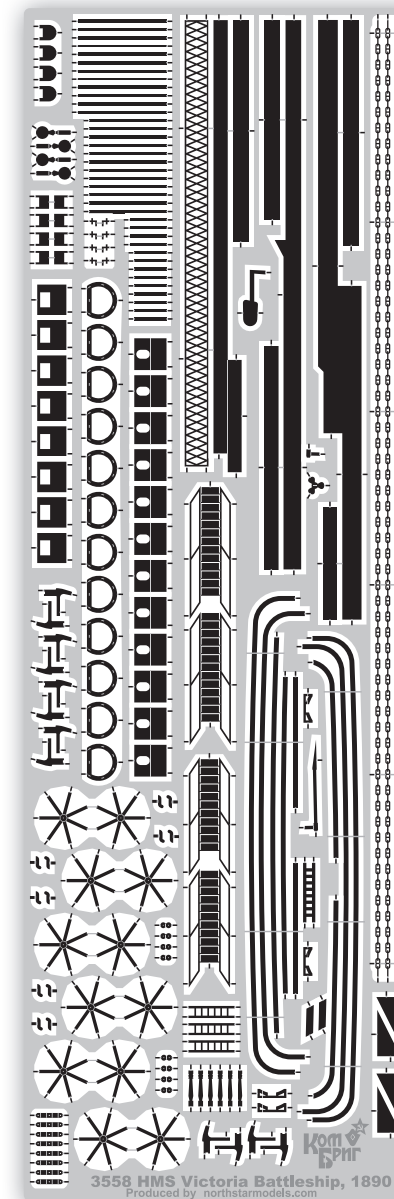
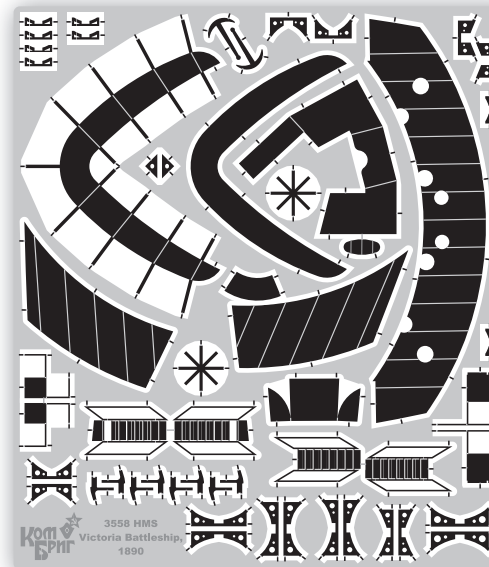
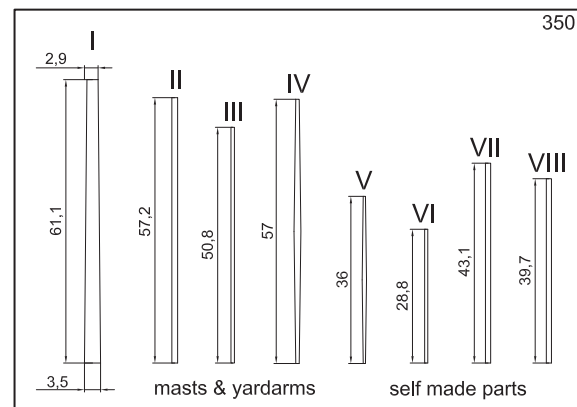
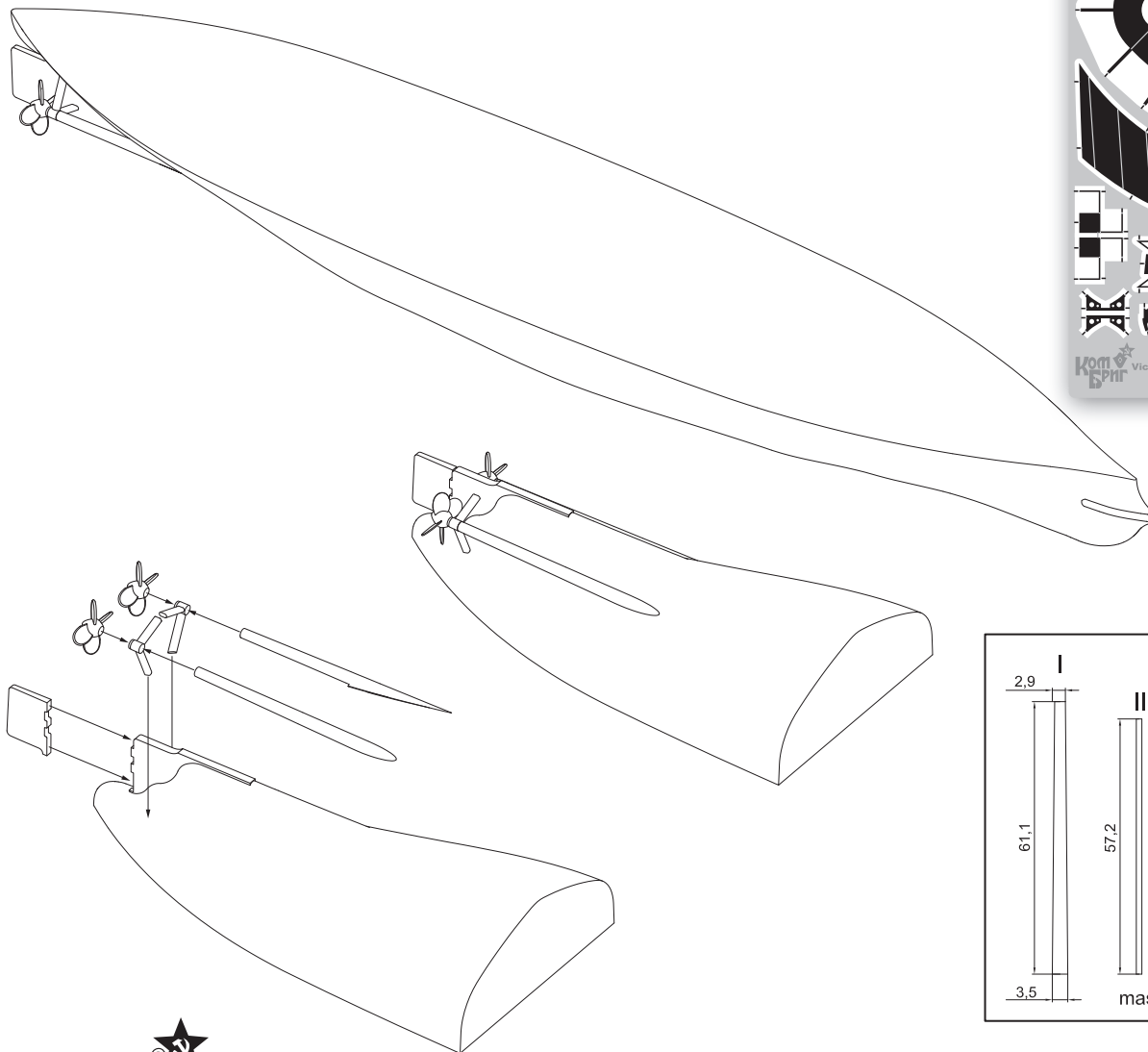

СХЕМА СБОРКИ МОДЕЛИ ASSEMBLY INSTRUCTIONS

4

HMS "VICTORIA"

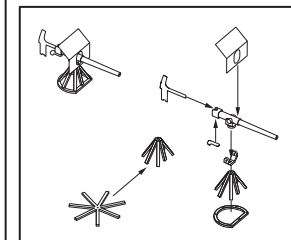
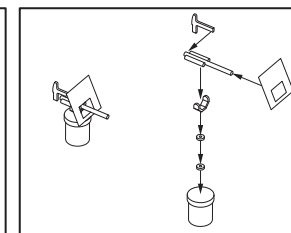
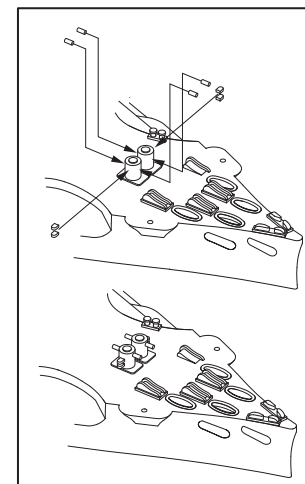
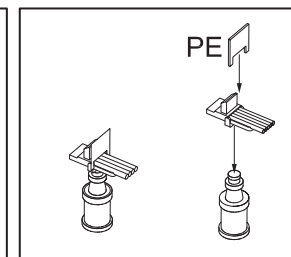
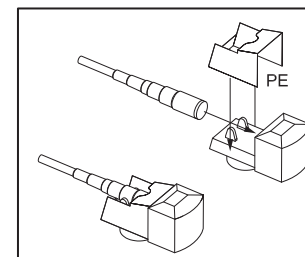
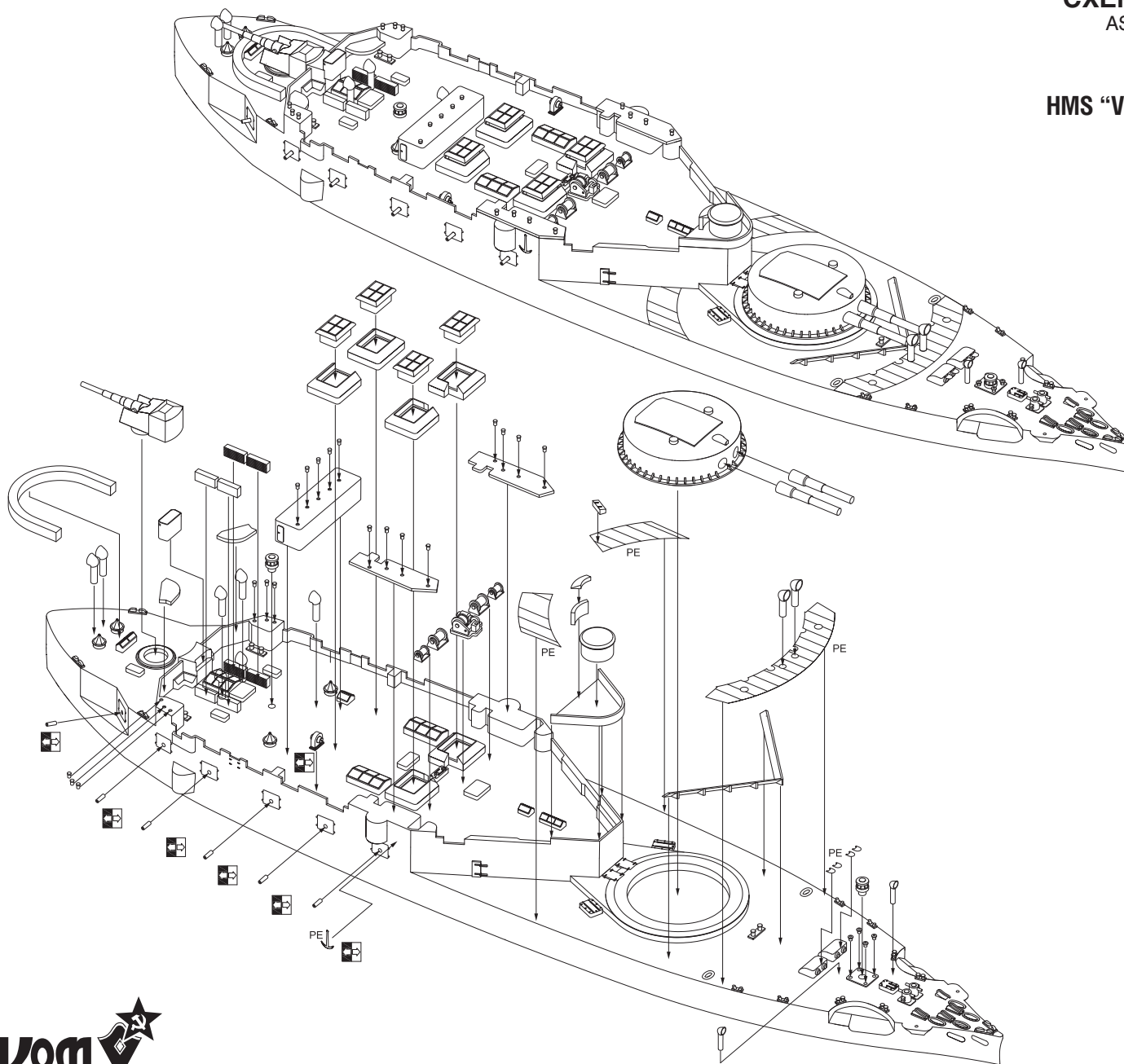

СХЕМА СБОРКИ МОДЕЛИ ASSEMBLY INSTRUCTIONS

4

HMS "SANS PAREIL"

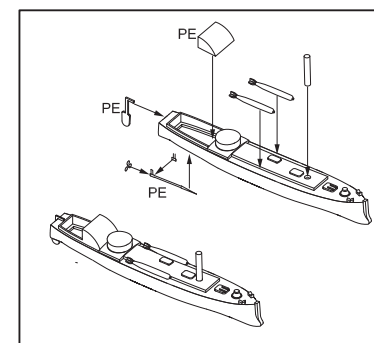
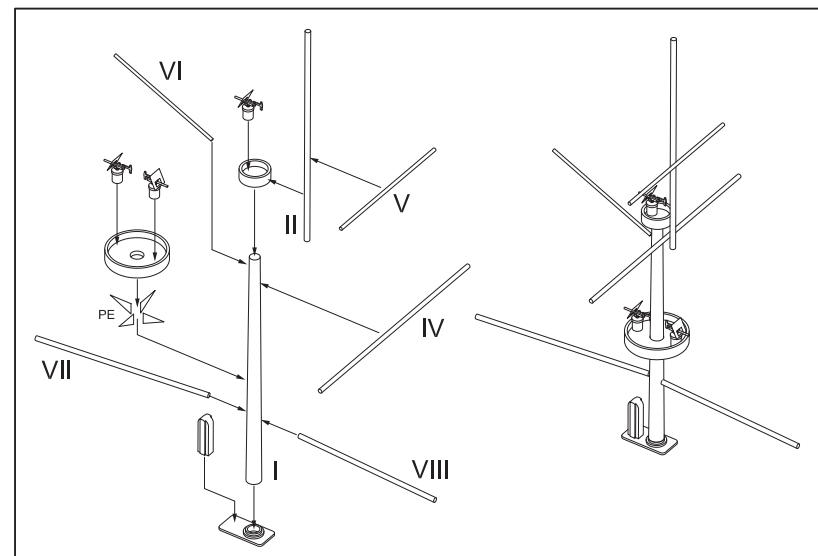
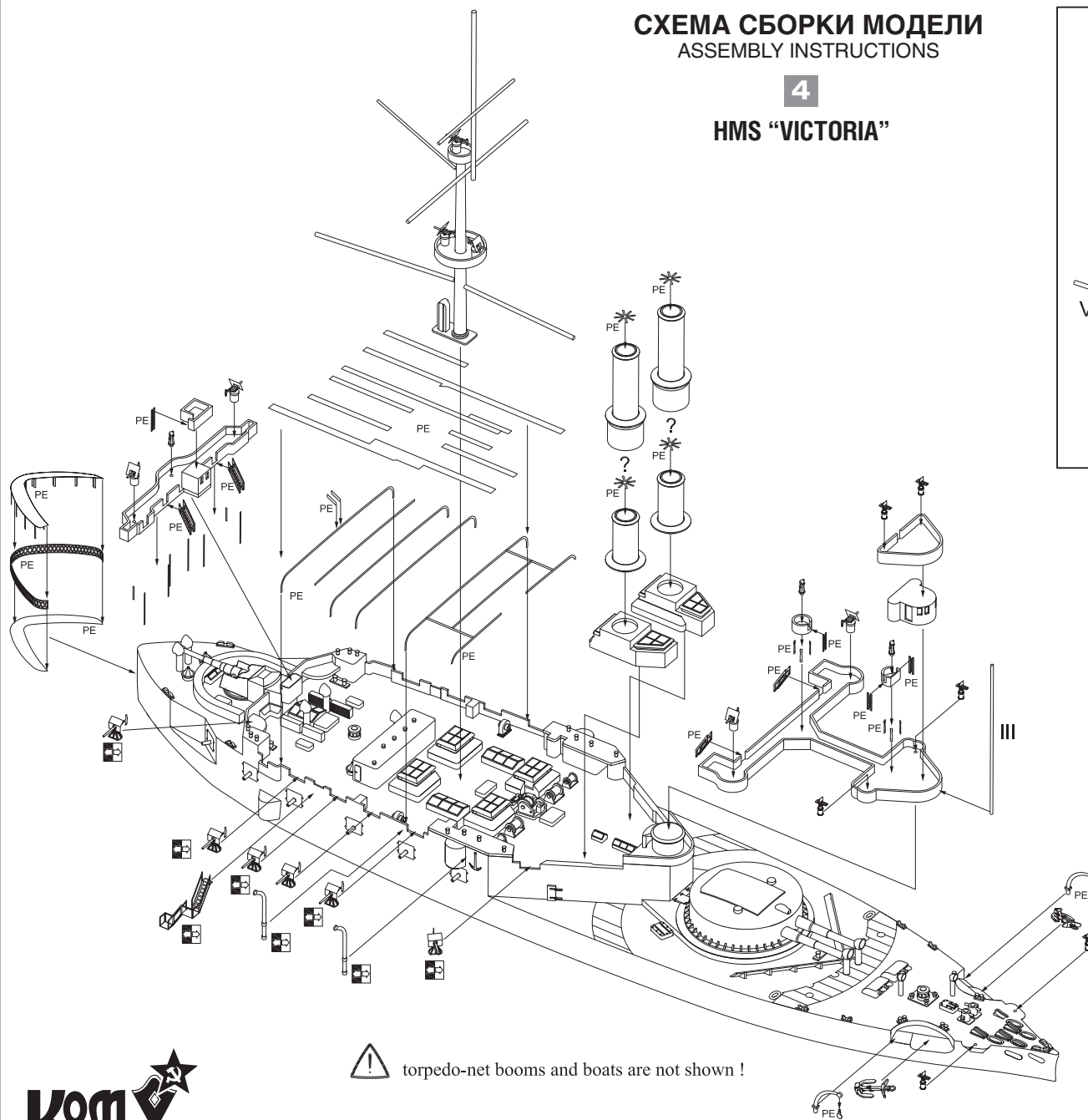
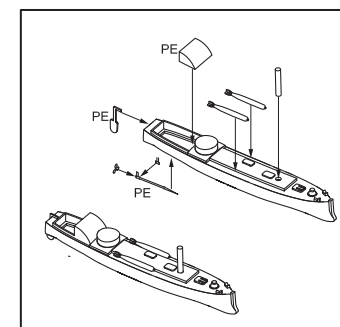
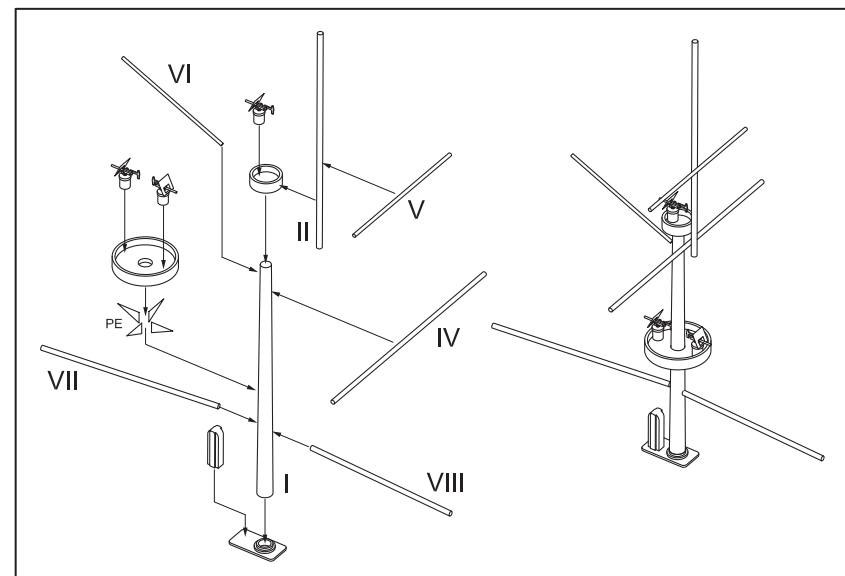
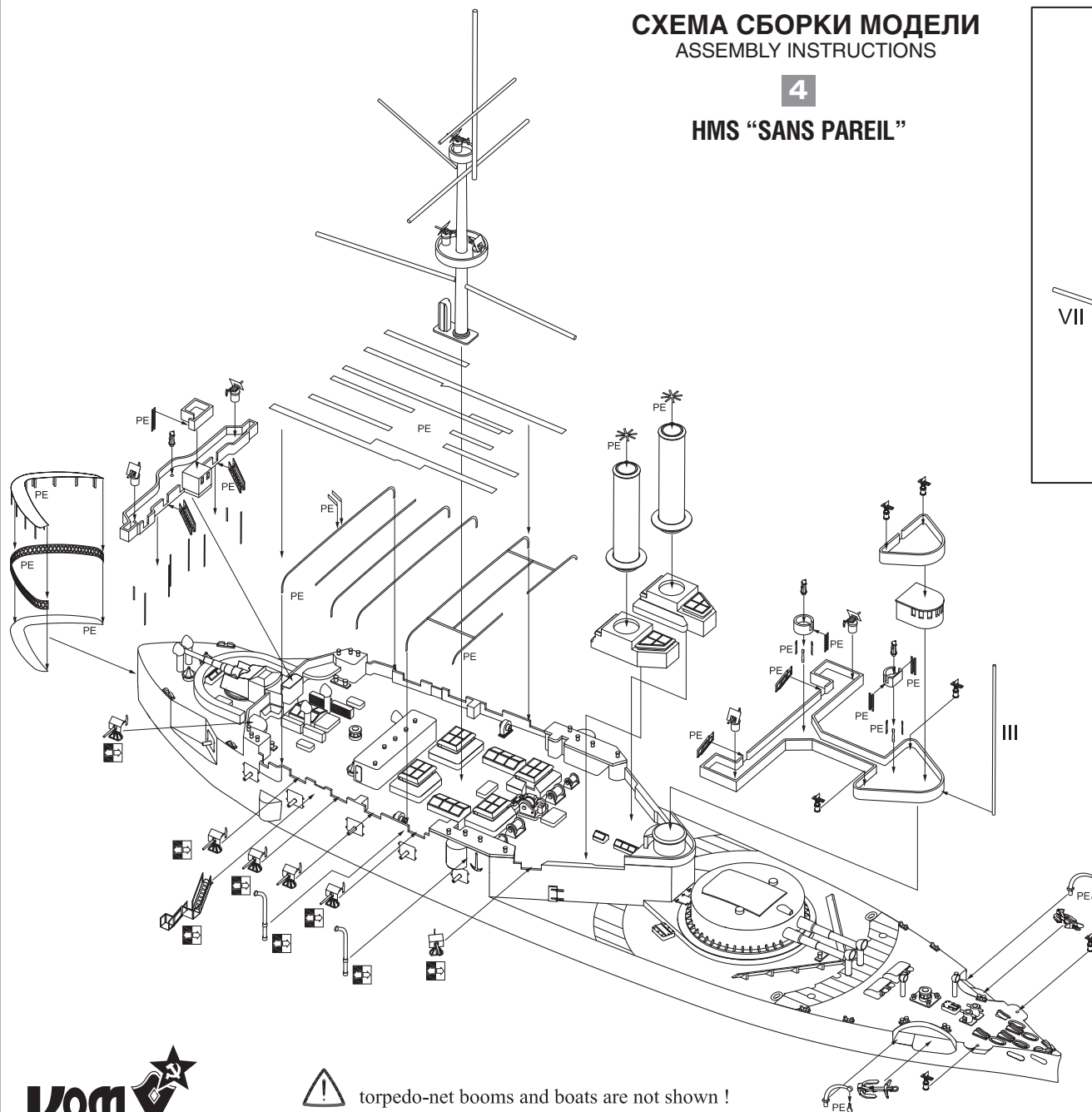

torpedo-net booms and boats are not shown !