

КАНОНЕРСКАЯ ЛОДКА

MAYA

IJN GUNBOAT 1888

1:700

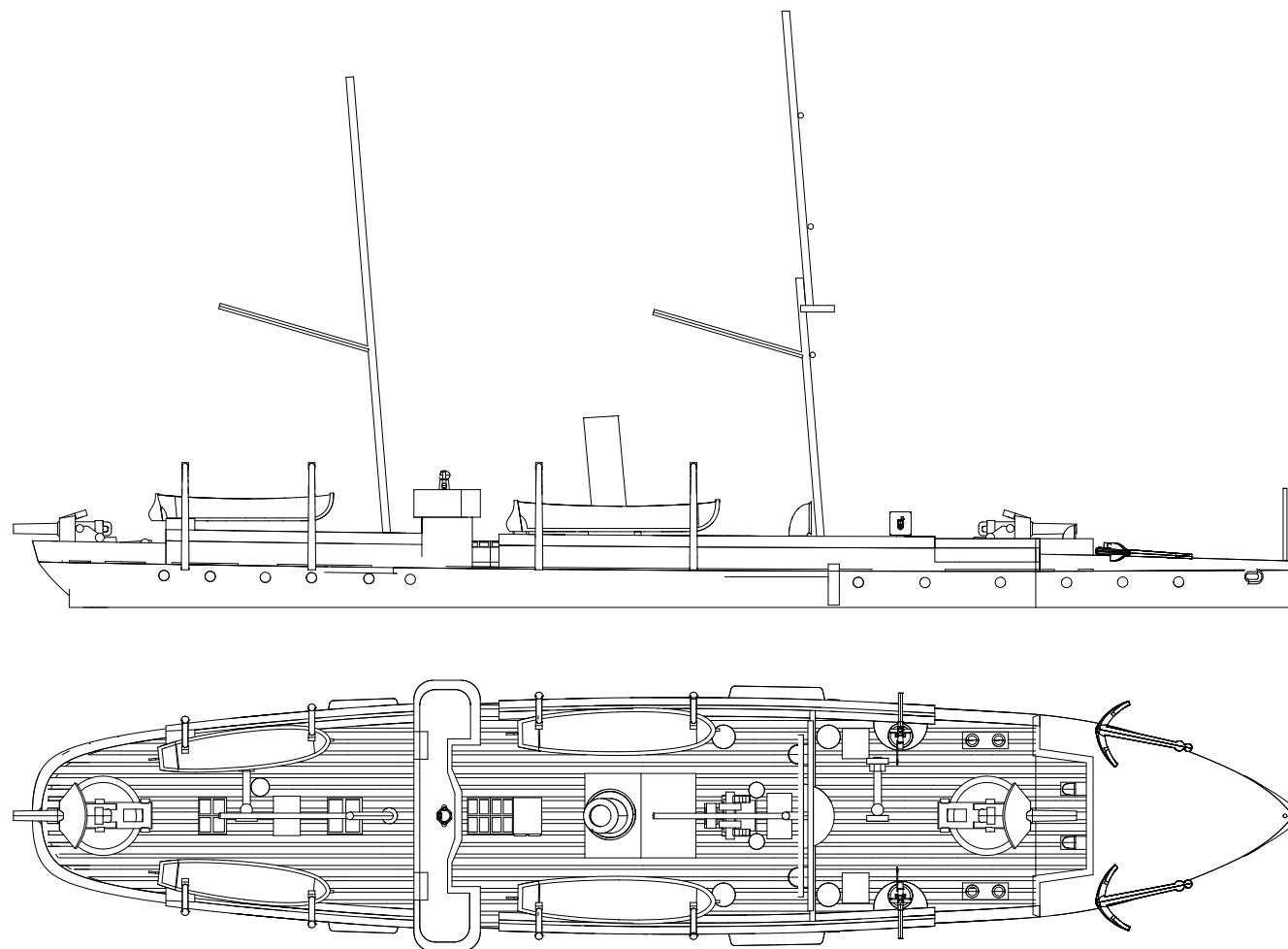

Тактико-технические характеристики:

Displacement:	624 t
Length:	47,0 m
Beam:	8,2 m
Draught:	2,95 m

Propulsion:	reciprocating steam engine 2 shafts, 2 boilers 950 л. с.
Speed:	11,0 уз.
Range:	60 tons coal

Complement:	104
--------------------	-----

Armament:

2 x 150 mm (6 in) Krupp L/22 breech-loading gun
2 x 1-inch Nordenfelt guns

Maya was laid down at the Onohama Shipyards in Kobe on 1 June 1885 and launched on 18 August 1886. She was completed on 20 January 1888.

Maya saw combat service in the First Sino-Japanese War of 1894-1895 under the command of Lieutenant Commander Hashimoto Masaaki, patrolling between Korea, Dairen and escorting Japanese transports.

On 21 March 1898, Maya was re-designated as a second-class gunboat, and was used for coastal survey and patrol duties.

During the Russo-Japanese War of 1904-1905, Maya assisted in the Siege of Port Arthur, and also made a sortie up the Yalu River to attack Russian positions, and was part of the Japanese fleet for the invasion of Sakhalin. [4] She was rearmed with four 4.7 in (120 mm) QF guns and two quadruple 1-inch Nordenfelt guns in 1906.

She was removed from active combat status on 16 May 1908, and was used as a training vessel at the Yokosuka Naval District. Maya was removed from the navy list and transferred to the Home Ministry on 1 December 1911[3] for

use as a police boat in Kobe harbor. She was subsequently demilitarized and sold in December 1918 to a commercial trading firm, Ikeda Shoji, who used her as a transport until she was scrapped in 1932.

СХЕМА СБОРКИ МОДЕЛИ ASSEMBLY INSTRUCTIONS

1



СХЕМА СБОРКИ МОДЕЛИ ASSEMBLY INSTRUCTIONS

2



masts & yardarms
self made parts

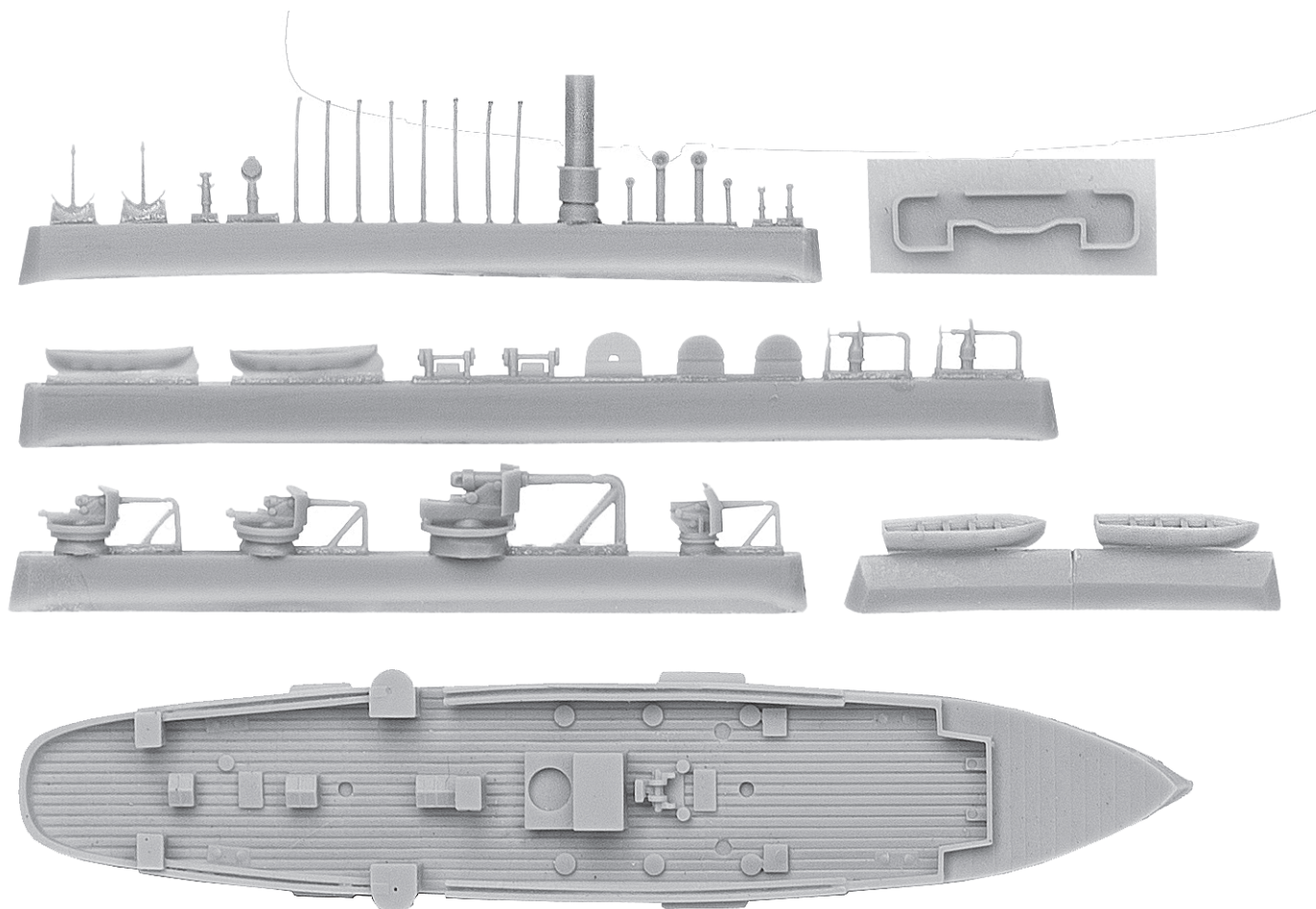
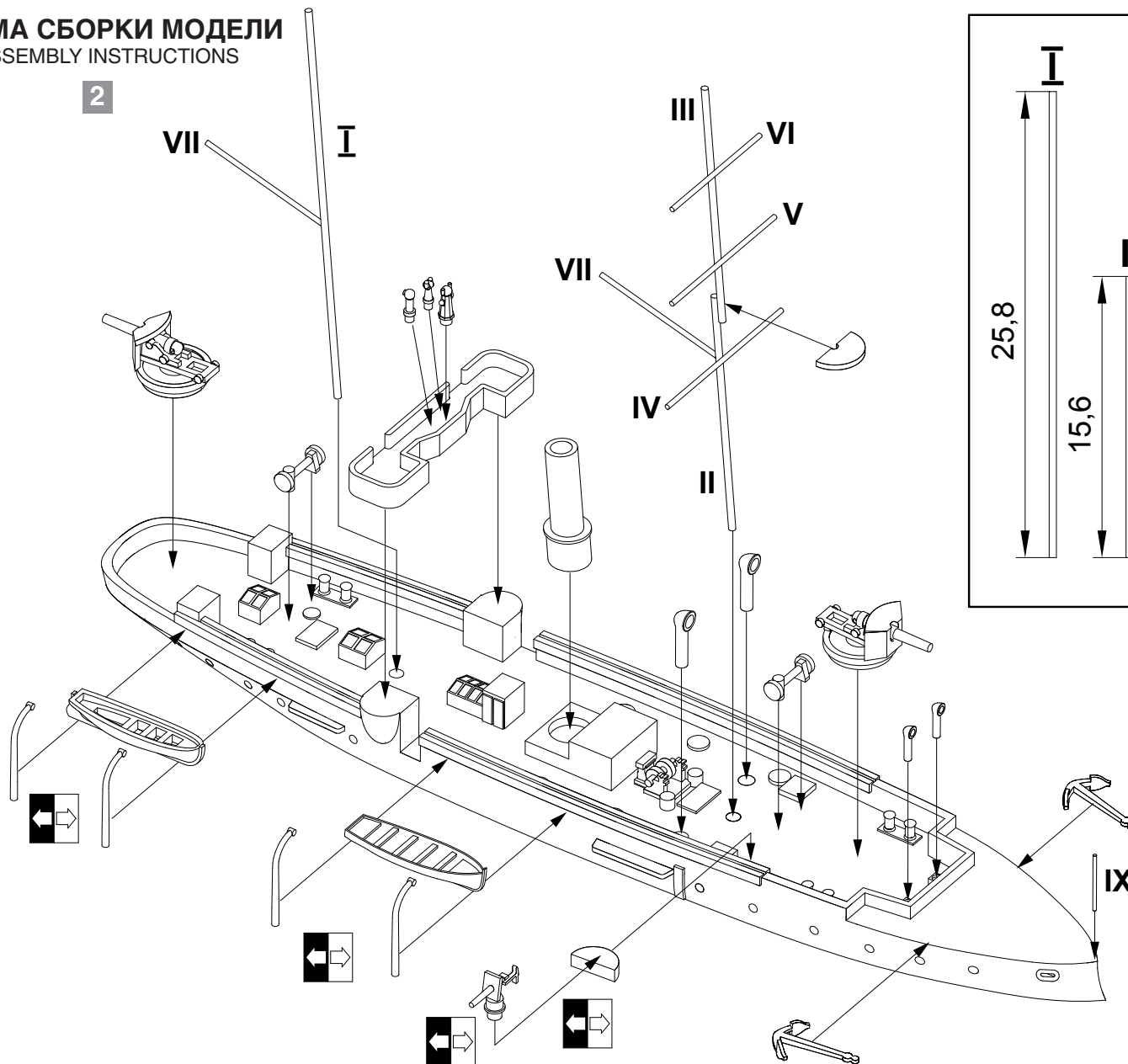